

TITLE G502 FITTING PART L

CODE

Pitched roof. Ventilated loft eaves detail
for roof pitches down to 22.5 degrees

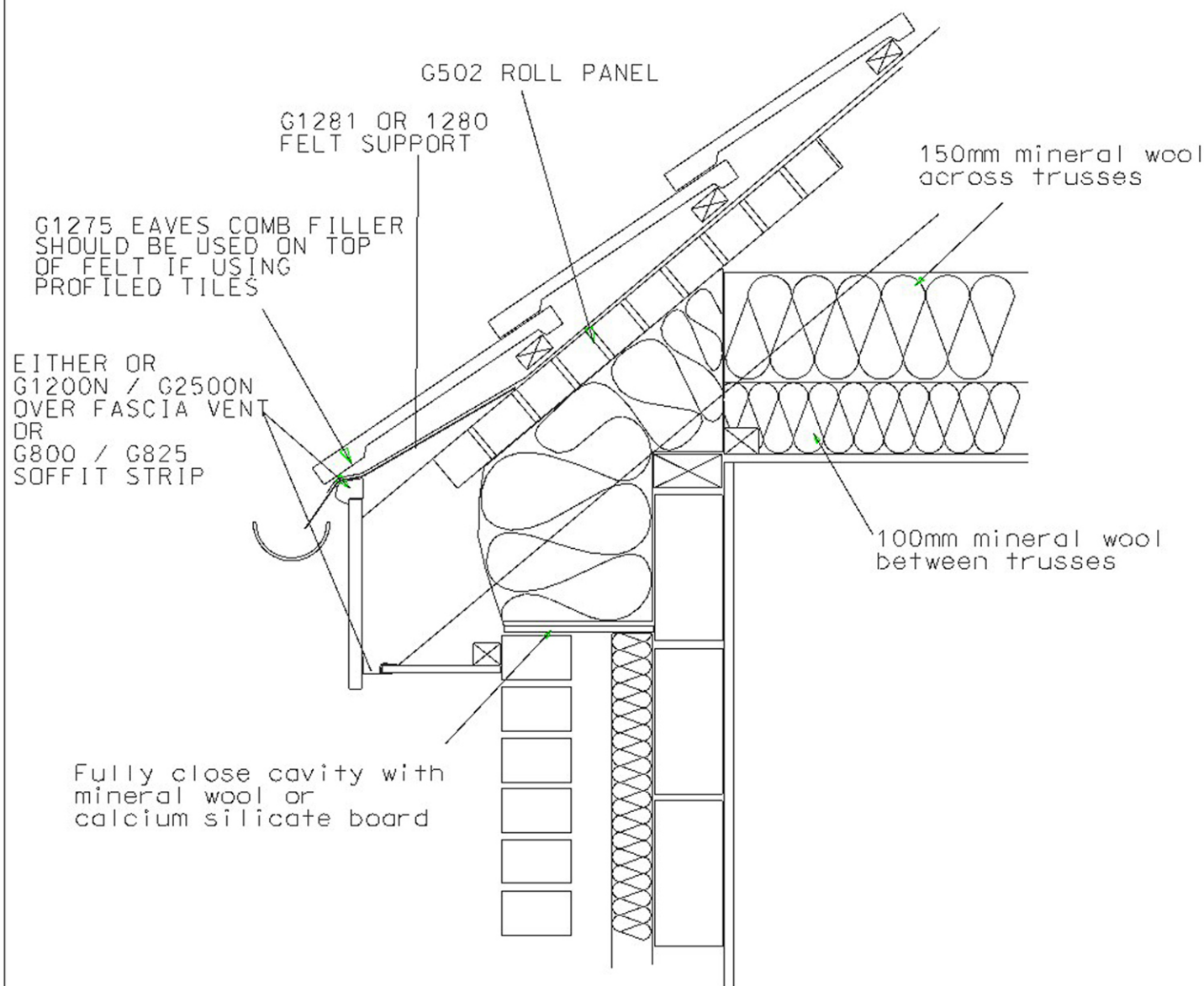

Note
Soffit board ventilation can also be used by removing the Over fascia vent and replacing with G800 or G825 soffit strip clipped to the soffit board depending on 10 or 25mm airflow requirements

MANTHORPE BUILDING PRODUCTS LIMITED
MANTHORPE HOUSE, BRITAIN DRIVE,
CODNOR GATE BUSINESS PARK,
RIPLEY, DERBYSHIRE DE5 3ND.

TELE: 01773 743555
FAX: 01773 748736

Drn

Date

18/07/02

DRG No

8180

ISSUE

A

The Company maintains a policy of continuous development of its product range and reserve the right to amend the specification without notice.