

TITLE GENERAL FITTING INSTRUCTIONS FOR STEPPED CAVITY TRAYS

CODE

THE CORNER OF THE TRAY SHOULD BE 75mm OFF FINISHED ROOFLINE

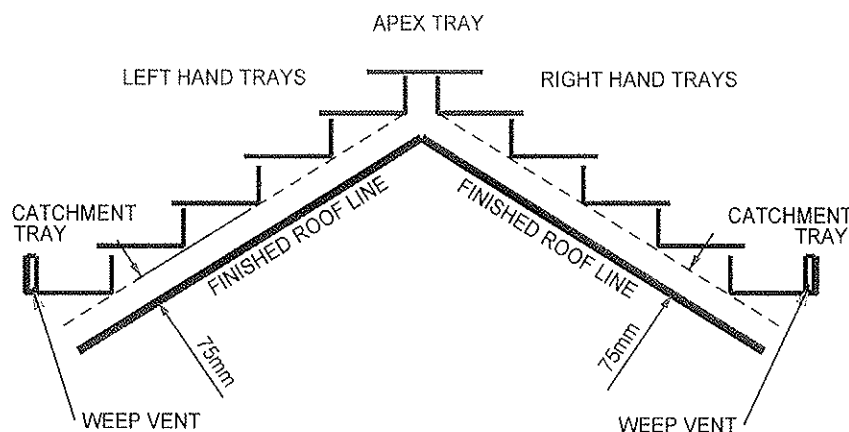

A dummy truss should be positioned at roof abutment 75mm off the finished roof line as shown. One cavity tray should be placed on every course of the abutment. The corner of each cavity tray should be aligned with the dummy truss to achieve the correct spacing of trays and stepped flashing on completion.

#### NOTE

If a secret gutter is being used and the upstand is higher than 75mm above the finished roof line then the position of the trays will have to be adjusted accordingly.

DO NOT FIT TRAYS INTO THE NEAREST PERPEND

BRICKS WILL NEED TO BE CUT TO ACHIEVE CORRECT PITCH BUT WILL BE HIDDEN BY LEAD FLASHING ON COMPLETION.

FOR FURTHER INFORMATION  
DETAILS SEE RELEVANT  
DRAWING

DO NOT DRY BED TRAYS

All cavity trays and masonry should be bedded on mortar. The area around the trays should be flush pointed.

KEEP TRAYS AND CAVITY CLEAR

During construction mortar should be prevented from falling into the trays and cavity. Any mortar that does fall into the trays should be removed before completion.

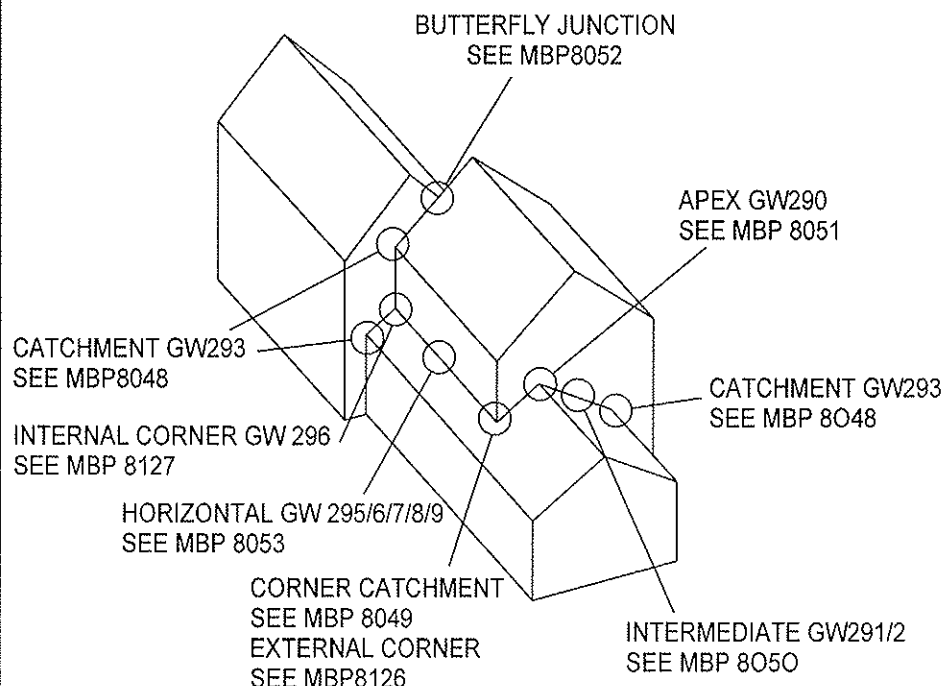

#### LEADED TRAYS

After fitting the trays and mortar is dry the lead should be dressed as shown. This should be easily done if the tray has been positioned correctly.

#### UNLEADED TRAYS

When mortar is dry and the wall is stable the mortar strips should be removed to leave a 25mm deep gap to fix lead flashing into using lead wedges as per normal practice. The lead should then be dressed down and pointed using a suitable flexible sealant.

MANTHORPE BUILDING PRODUCTS LIMITED  
MANTHORPE HOUSE, BRITAIN DRIVE,  
CODNOR GATE BUSINESS PARK,  
RIPLEY, DERBYSHIRE DE5 3ND.

TELE: 01773 743555  
FAX: 01773 748736

Dm

MC

Date

7/4/99

DRG No

8045

ISSUE

B

The Company maintains a policy of continuous development of its product range and reserve the right to amend the specification without notice.

TITLE CATCHMENT FITTING DETAILS

CODE

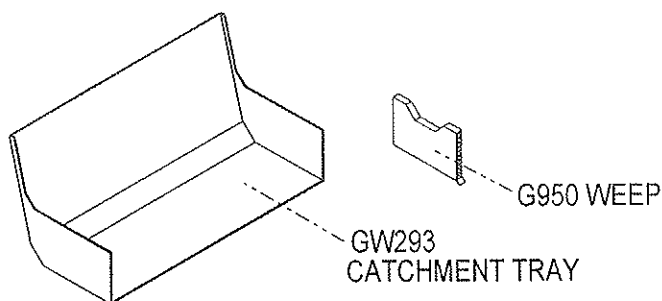

The GW293 Catchment Tray has a stop-end at both ends forming an enclosed tray. This collects any water from trays above and discharges it out through a G950 Weep Vent.

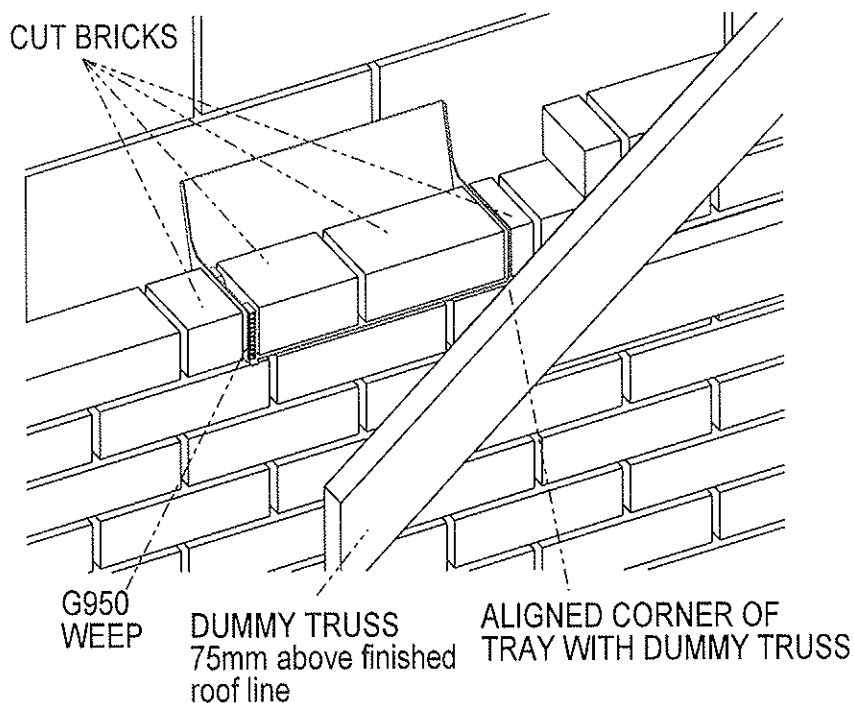

The Catchment Tray is located at the lowest point of the abutment and is generally the first tray to be fitted. This tray should be mortared into position with the corner 75mm off the finished roof line and if possible over the gutter. To achieve this it is normally necessary to cut bricks.

G950 Weep Vents should be fitted as shown. Care should be taken not to block the weep vent with mortar or debris.

DO NOT FORGET TO FIT  
A G950 WEEP VENT

DO NOT DRY BED TRAYS

## SHORT LEADED TRAY DETAIL SHOWN

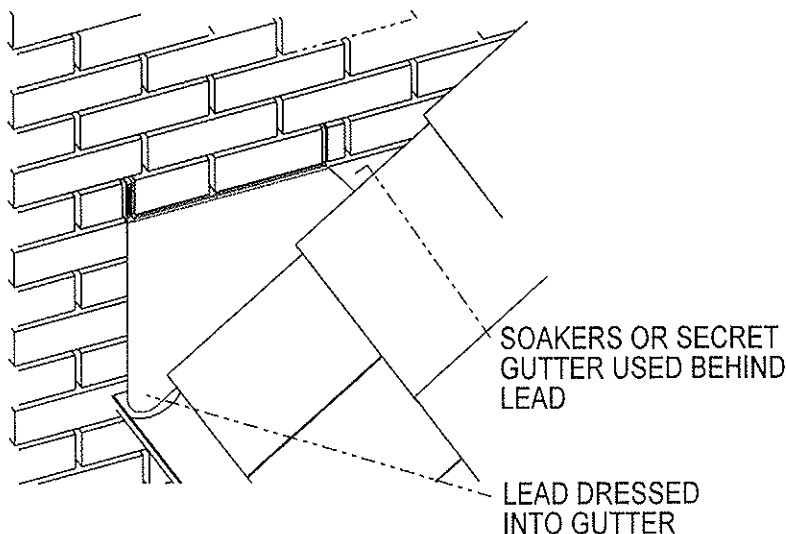

After fitting the tray and mortar is dry lead should be fitted as shown, this should be easily done if the tray has been positioned correctly. If there is a gutter under the tray then the lead should be dressed into it as shown.

Note: Mortar is not shown for clarity

MANTHORPE BUILDING PRODUCTS LIMITED  
MANTHORPE HOUSE, BRITAIN DRIVE,  
CODNOR GATE BUSINESS PARK,  
RIPLEY, DERBYSHIRE DE5 3ND.

TELE: 01773 743555  
FAX: 01773 748736

Drn

MC

Date

7/4/99

DRG No

8048

ISSUE

A

The Company maintains a policy of continuous development of its product range and reserve the right to amend the specification without notice.

TITLE

CORNER CATCHMENT FITTING DETAIL

CODE

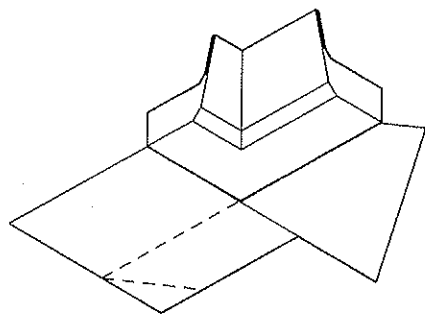

Left Hand GW293CCLH  
shown with short lead attached

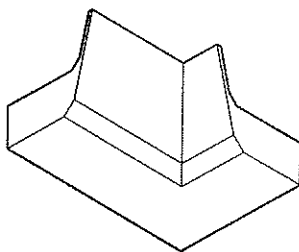

Right Hand GW293CCRH

The GW293CC Corner Catchment Tray is formed in a 'L' shape with a stop-end at both ends. Its function is to collect any water from trays above and discharge it through a G950 Weep Vent. It is used when a stepped roof abutment terminates at a corner.

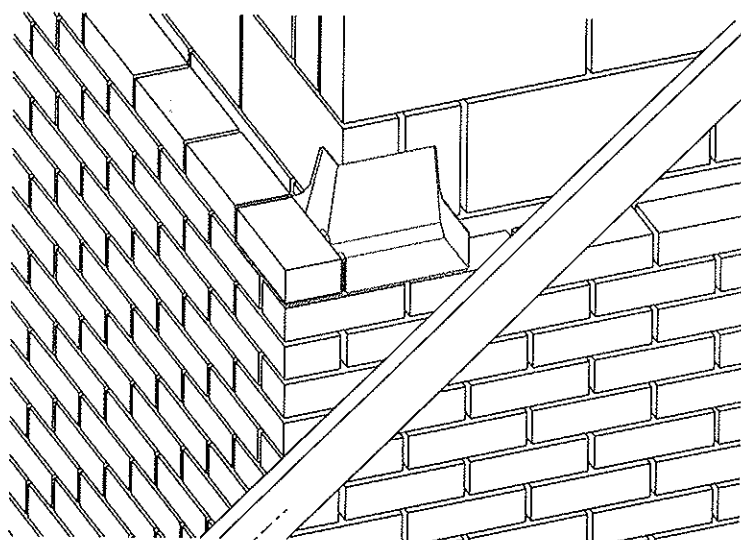

DUMMY TRUSS  
75mm above finished  
roof line

The Corner Catchment Tray should be positioned with the corner of the tray 75mm of the finished roof line (dummy truss line) as shown. It will not always be possible to achieve exactly 75mm. In this situation a number of dry runs should be carried out to locate the corner of the tray as close as possible to the dummy truss line.

As with all trays it may be necessary to cut bricks to achieve correct positioning.

Note.  
For low pitch applications see additional sheet\*\*\*\*\*

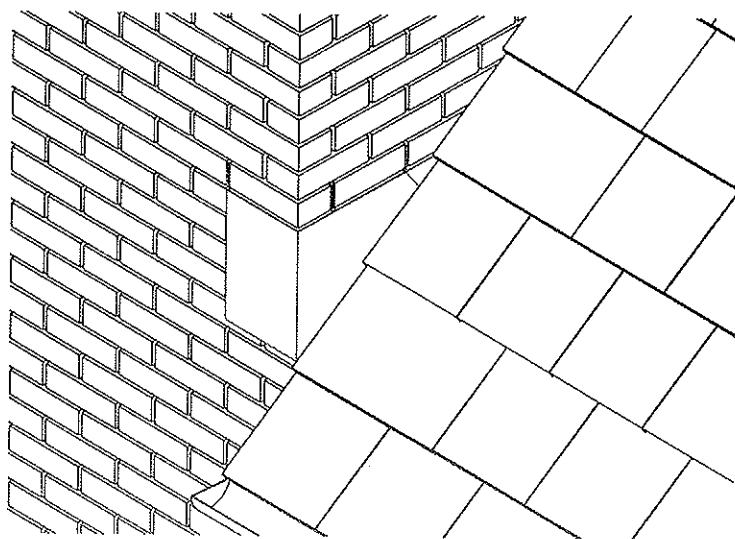

## LEADED TRAYS

After fitting the trays and mortar is dry the lead should be dressed as shown.

## UNLEADED TRAYS

When mortar is dry and the wall is stable the blue foam strips should be raked out to leave a 25mm deep gap to fix lead flashing into using lead wedges as per normal practice. The lead should then be dressed down and pointed using a suitable flexible sealant.

Note:  
For long lead applications the lead flashing should be welded see sheet\*\*\*\*\*

Note: Mortar is not shown for clarity

MANTHORPE BUILDING PRODUCTS LIMITED  
MANTHORPE HOUSE, BRITAIN DRIVE,  
CODNOR GATE BUSINESS PARK,  
RIPLEY, DERBYSHIRE DE5 3ND.

TELE: 01773 743555  
FAX: 01773 748736

Dm

MC

Date

4/3/99

DRG No

8049

ISSUE

A

The Company maintains a policy of continuous development of its product range and reserve the right to amend the specification without notice.

TITLE

INTERMEDIATE TRAYS FITTING DETAILS

CODE

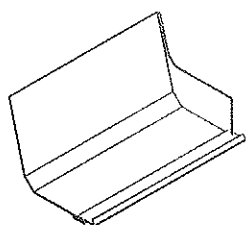

GW292 Intermediate tray  
shown with mortar strip

The GW292 Left Hand (shown) and GW291 Right Hand Intermediate Trays have a stop-end at one end of the tray. This tray collects any water from above and channels it down to the next tray.

Mortar strip not shown  
in below detail for clarity

ALIGNED CORNER OF  
TRAY WITH DUMMY TRUSS

CUT BRICKS

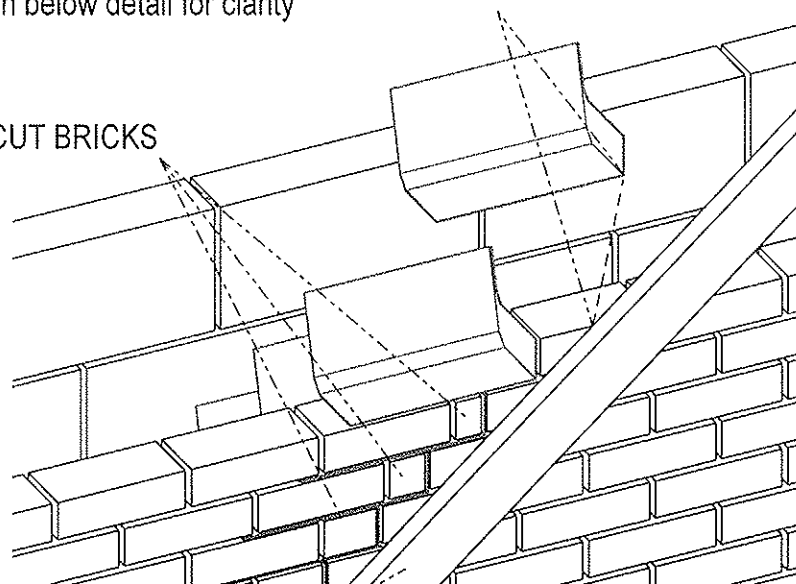

DUMMY TRUSS  
75mm above finished  
roof line

Intermediate trays are positioned on every brick course above the Catchment Tray up to the apex or termination of the abutment. The corner of each tray should be positioned 75mm off the finished roofline using a dummy truss as a guide. To achieve the correct pitch it will be necessary to cut bricks but all cut brick joints will be covered by lead flashing on completion.

All cavity trays and masonry should be bedded on mortar. The area around the trays should be flush pointed.

**DO NOT DRY BED TRAYS**

SHORT LEADED TRAY DETAIL SHOWN

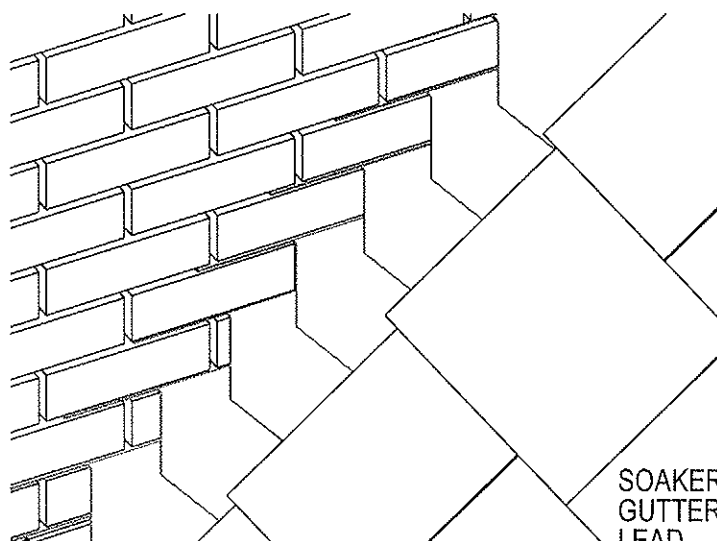

SOAKERS OR SECRET  
GUTTER USED BEHIND  
LEAD

Note: mortar is not shown for clarity

MANTHORPE BUILDING PRODUCTS LIMITED  
MANTHORPE HOUSE, BRITAIN DRIVE,  
CODNOR GATE BUSINESS PARK,  
RIPLEY, DERBYSHIRE DE5 3ND.

TELE: 01773 743555  
FAX: 01773 748736

Drm

MC

Date

10/5/99

DRG No

8050

The Company maintains a policy of continuous  
development of its product range and reserve  
the right to amend the specification without notice.

ISSUE

A

TITLE

INTERMEDIATE BLOCKWORK TRAY FITTING DETAILS

CODE

GW292B

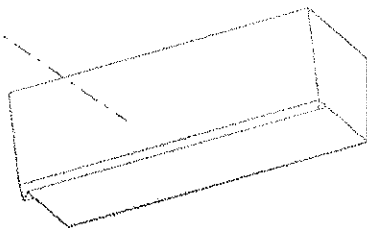

PERPEND  
PROTECTOR

The GW292B Left Hand (shown) and GW291B Right Hand Intermediate Blockwork trays are larger in size than standard trays to accommodate the greater course height of blockwork

These trays are fitted in the same way as standard trays but have an additional perpend protector to form a barrier against wind driven rain.

ALIGNED CORNER OF  
TRAY WITH DUMMY TRUSS

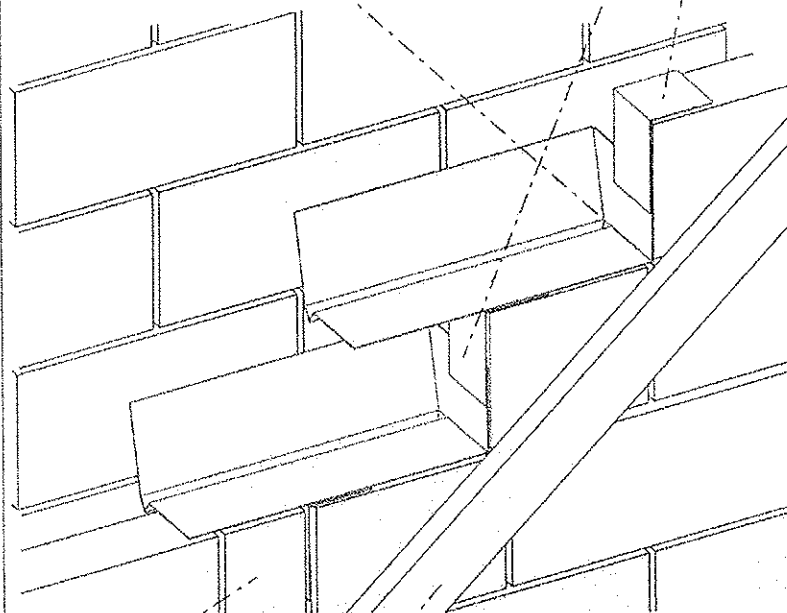

CUT BLOCKS

DUMMY TRUSS  
75mm above finished  
roof line

Intermediate trays along with a perpend protector are positioned on every block course above a standard Catchment Tray up to a blockwork Apex Tray or termination of the abutment. The corner of each tray should be positioned 75mm off the finished roofline using a dummy truss as a guide. To achieve the correct pitch it will be necessary to cut blocks but all cut blocks joints will be covered by lead flashing on completion.

All cavity trays and masonry should be bedded on mortar. The area around the trays should be flush pointed.

DO NOT DRY BED TRAYS

For detail on general fitting installation please refer to sheet 8045

## LEADED TRAYS

After fitting the trays and when the mortar is dry the lead should be dressed as shown.

## UNLEADED TRAYS

When mortar is dry and the wall is stable the blue foam strips should be raked out to leave a 25mm deep gap to fix lead flashing into using lead wedges as per normal practice. The lead should then be dressed down and pointed using a suitable flexible sealant.

Note: mortar is not shown for clarity

MANTHORPE BUILDING PRODUCTS LIMITED  
MANTHORPE HOUSE, BRITAIN DRIVE,  
CODNOR GATE BUSINESS PARK,  
RIPLEY, DERBYSHIRE DE5 5ND.

TELE: 01773 743555  
FAX: 01773 748736

Drn

MC

Date

17/9/99

DRG No

8068

ISSUE

A

The Company maintains a policy of continuous development of its product range and reserves the right to amend this specification without notice.

TITLE

APEX TRAY FITTING DETAILS

CODE

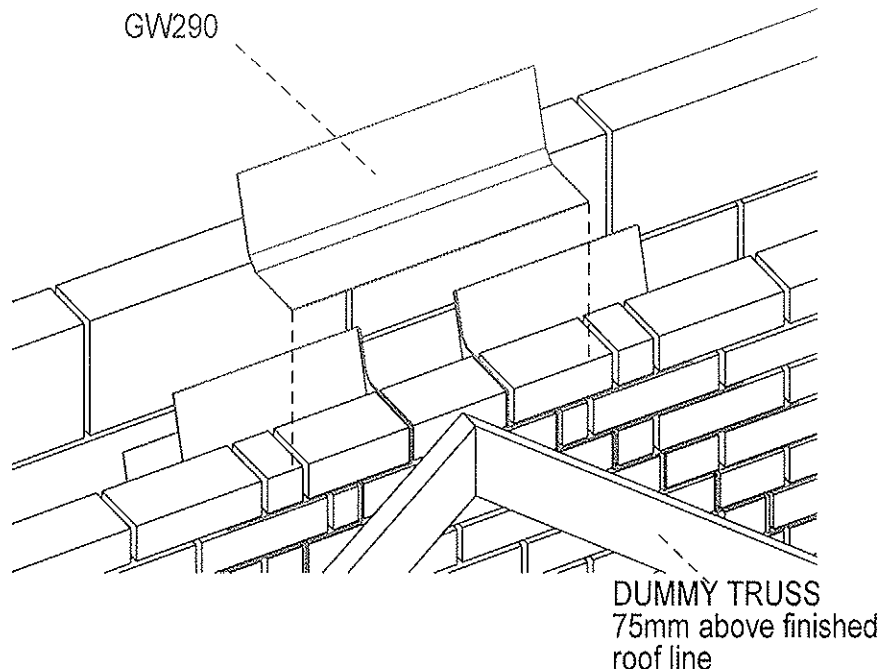

SHORT LEADED TRAY DETAIL SHOWN

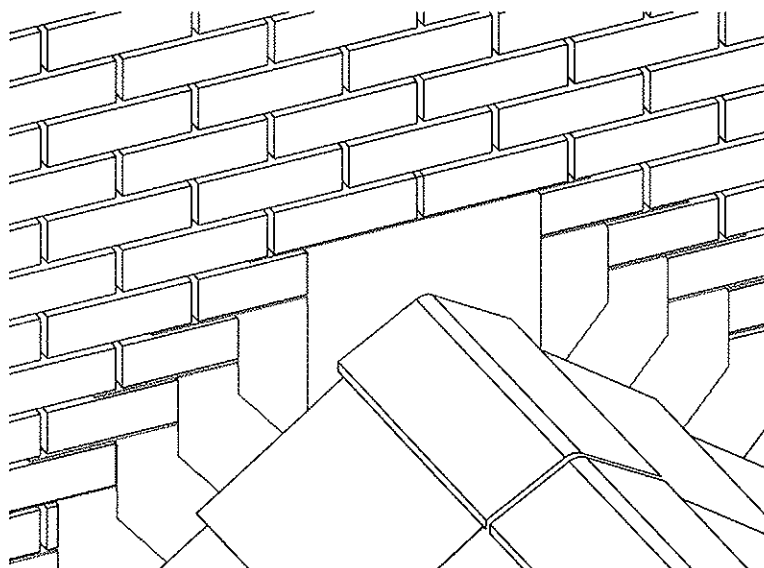

LEAD SADDLE DETAIL

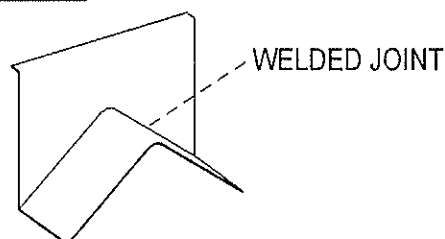

Note: mortar is not shown for clarity

The GW290 Apex Tray protects the ridge or apex area, collecting any water from above and directing it to each side into the Intermediate Trays.

The Apex Tray is located at the highest point of the abutment above the ridge or apex and is generally the last tray to be fitted. This tray should be positioned centrally above the last two Intermediate Trays ensuring there is an overlap between the Apex Tray and both Intermediate trays.

All cavity trays and masonry should be bedded on mortar. The area around the trays should be flush pointed.

## DO NOT DRY BED TRAYS

## LEADED TRAYS

After fitting the trays and mortar is dry the lead should be dressed as shown. If long lead is being used to dress over roof tiles then an additional lead saddle should be welded to the apex lead as shown. For further information on lead work refer to the Lead Sheet Association, 'Lead sheet manual'.

## UNLEADED TRAYS

When mortar is dry and the wall is stable the blue foam strips should be raked out to leave a 25mm deep gap to fix lead flashing into using lead wedges as per normal practice. The lead should then be dressed down and pointed using a suitable flexible sealant.

MANTHORPE BUILDING PRODUCTS LIMITED  
MANTHORPE HOUSE, BRITAIN DRIVE,  
CODNOR GATE BUSINESS PARK,  
RIPLEY, DERBYSHIRE DE5 3ND.

TELE: 01773 743555  
FAX: 01773 748736

Drm

MC

Date

10/5/99

DRG No

8051

ISSUE

A

The Company maintains a policy of continuous development of its product range and reserve the right to amend the specification without notice.

TITLE GENERAL FITTING DETAIL UNLEADED TRAYS

CODE

50 -100MM

102.5MM

MORTAR STRIP

BED TRAY TOP AND  
BOTTOM WITH MORTAR

FITTING LEAD

Lead  
wedge

Sealant

① Wait until mortar is dry and wall is stable then pull out mortar strip to leave a 25mm slot

② Push lead into the gap ensuring it fits under the Cavity Tray. Secure lead flashing using lead wedges as per normal practice.

③ Dress lead down into position and point with a suitable flexible lead sealant.

For further information on the fitting and dressing of lead refer to the 'Lead Sheet Manual' available from the Lead Sheet Association.

MANTHORPE BUILDING PRODUCTS LIMITED  
MANTHORPE HOUSE, BRITAIN DRIVE,  
CODNOR GATE BUSINESS PARK,  
RIPLEY, DERBYSHIRE DE5 3ND.

TELE: 01773 743555  
FAX: 01773 748736

Drn

MC

Date

7/4/99

DRG No

8046

ISSUE

A

The Company maintains a policy of continuous development of its product range and reserve the right to amend the specification without notice.