

## Plaster Stop Bead

Provides clean, neat edges to two coat plaster/render work at openings or abutments onto other wall surfaces or ceiling finishes. Galvanised for internal applications, Stainless Steel for external use and high condensation and moisture areas.

Code	Qty /Box	Length (mm)	Plaster depth	Use
PS10/2.4	50	2400	10mm	ⓘ
PS10/3.0	50	3000	10mm	ⓘ
PS13/2.4	50	2400	13mm	ⓘ
PS13/3.0	50	3000	13mm	ⓘ
PS16/3.0	50	3000	16mm	ⓘ
PS19/3.0	50	3000	19mm	ⓘ
PS10/3.0/SS	10 or 50	3000	10mm	ⓔ
PS13/3.0/SS	10 or 50	3000	13mm	ⓔ
PS16/3.0/SS	10 or 50	3000	16mm	ⓔ
PS19/3.0/SS	10 or 50	3000	19mm	ⓔ

Stainless steel products suffixed 'SS'.

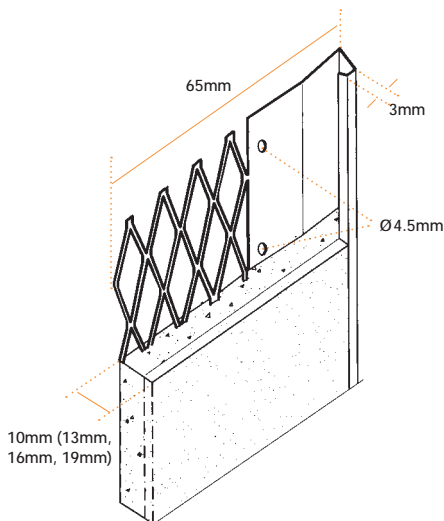

**PS 13, 16, 19 dimensions in brackets.**  
Plaster depth – 10mm, 13mm, 16mm, 19mm  
Flange width – 65mm  
Galvanized Steel to BSEN 10327-DX51D+Z275  
Stainless Steel to BSEN 10088-2-1.4301

## Movement Bead

The function of this bead is to allow for movement between adjoining surface finishes resulting from differential expansion or settlement. Allowable movement is  $\pm 3\text{mm}$ . Galvanised for internal applications, Stainless Steel for external use and high condensation and moisture areas.

Code	Qty /Box	Length (mm)	Plaster depth	Use
MB10/3.0 x10	10	3000	12mm	ⓘ
MB13/3.0 x10	10	3000	15mm	ⓘ
MB16/3.0 x10	10	3000	18mm	ⓘ
MB19/3.0 x10	10	3000	21mm	ⓘ
MB10/3.0/SS x10	10	3000	12mm	ⓔ
MB13/3.0/SS x10	10	3000	15mm	ⓔ
MB16/3.0/SS x10	10	3000	18mm	ⓔ
MB19/3.0/SS x10	10	3000	21mm	ⓔ

Stainless steel products suffixed 'SS'.  
All Movement Bead made to order.

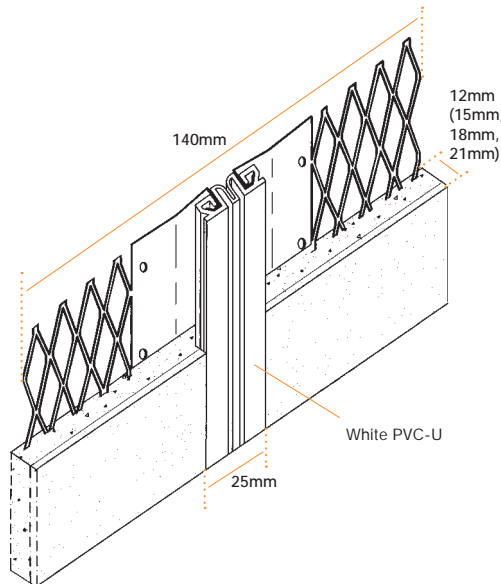

**MB 13, 16, 19 dimensions in brackets.**  
Plaster depth – 12mm, 15mm, 18mm, 21mm  
Flange width – 65mm  
Galvanized Steel to BSEN 10327-DX51D+Z275  
Stainless Steel to BSEN 10088-2-1.4301

## PVC Nose Punched Wing

A rigid and durable profile with the added benefit of a PVC-U nose which provides excellent edge protection for vulnerable corners where a high quality finish needs to be maintained despite heavy wear and repeated mechanical contact. The bead is suitable for **exterior use only in moderate to sheltered conditions up to two storeys.**

Code	Qty /Pack	Length (mm)	Use
SQPVC10/3.0	15	3000	ⓘ / ⓔ

All PVC Punched Wing made to order.

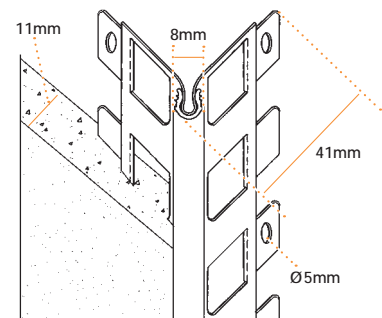

Plaster depth – 11mm  
Flange width – 41mm  
Galvanized Steel to BSEN 10327-DX51D+Z275